

# **xiaomi** Smart Tower Fan 2 User Manual



## Safety Instructions

Read this manual carefully before use, and retain it for future reference.

---

### WARNINGS

Improper use may lead to electric shocks, fire, personal injury, or other damage.

---

- This appliance can be used by children aged from 8 years and above and persons with reduced physical, sensory or mental capabilities or lack of experience and knowledge if they have been given supervision or instruction concerning use of the appliance in a safe way and understand the hazards involved. Children shall not play with the appliance. Cleaning and user maintenance shall not be made by children without supervision.
- This appliance is not intended for use by persons (including children) with reduced physical, sensory or mental capabilities, or lack of experience and knowledge, unless they have been given supervision or instruction concerning use of the appliance by a person responsible for their safety.
- Children should be supervised to ensure that they do not play with the appliance.
- The appliance is only to be used with the power adapter <AD-D1401200200EU01> provided with the appliance.
- Ensure that the fan is switched off from the supply mains before removing the guard.
- If the power adapter is damaged, it must be replaced by the manufacturer, its service agent or similarly qualified persons in order to avoid a hazard.
- Under normal use of condition, this equipment should be kept a separation distance of at least 20 cm between the antenna and the body of the user.

- 
- Prior to cleaning or other maintenance, the appliance must be disconnected from the supply mains.
  - Do not use this fan in a place where it will easily fall over or where there are other unstable objects nearby.
  - Do not use the fan in extremely dusty environments to avoid damaging it.
  - Do not use this fan in hot and humid environments such as a bathroom.
  - Do not use the fan if its power adapter is damaged or its power plug is loose.
  - Do not use the fan if its rear grille is not installed, becomes loose, or comes off.
  - Do not allow children or adults who are incapable of operating this fan to use this product.
  - Do not attempt to disassemble or repair this fan by yourself.
  - Do not excessively pinch, bend, or twist the power cord to avoid exposing or breaking its core.
  - Do not poke fingers or foreign objects into the grilles or the rotating fan blade.
  - Keep hair and fabrics away from the fan to prevent them from being caught in the fan.
  - Do not use any improper power outlet.
  - Disconnect the fan from the electrical outlet before removing its rear grille.
  - The wiring containing the socket into which you wish to connect the fan must comply with the applicable standards and laws of the country and must be regularly inspected and provided with surge protection.

---

## PRECAUTIONS

### Installation

- To avoid electric shocks, fire, personal injury, or other damage, make sure the fan is properly installed according to the instructions in this user manual.
- Do not connect the fan to the electrical outlet until the fan is fully assembled.

### Transportation

- Disconnect the fan from power before moving it.
- When moving the fan, hold it steady to avoid damage to the fan itself or personal injuries caused by the fan falling down.

### Using the fan

- Stop using the fan immediately if it makes unusual sounds, gives off odors, gets too hot, topples over, shakes, or has other errors.
- Do not shake the fan manually so as to avoid damage to its internal mechanism.
- Do not lean on or tilt the fan while it is running.

### Power adapter

- Disconnect the fan from the electrical outlet before maintaining or moving it.
- Always unplug the power adapter by pulling the power plug rather than the cord.

# Package Contents

---

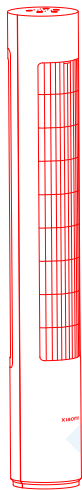

1  
Fan

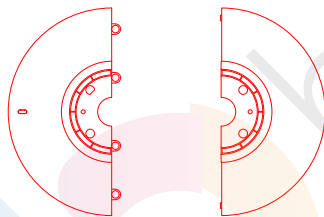

2  
Front Base

3  
Rear Base



4  
M5 Screw × 2



5  
Hex Key

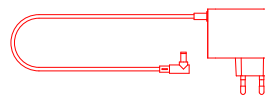

6  
Power Adapter

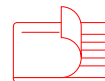

7  
User Manual

Note: Illustrations of the product, accessories, and user interface in the user manual are for reference purposes only. The actual product and functions may vary due to product enhancements.

## Product Overview

### Top View

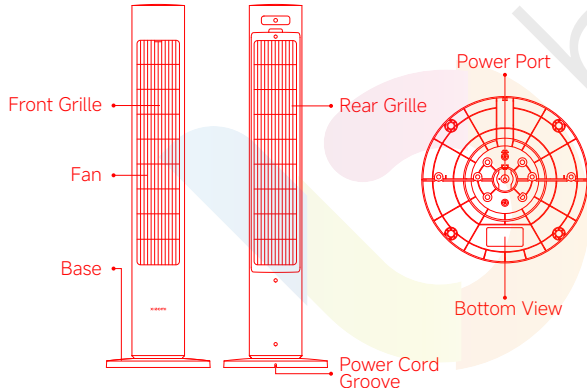
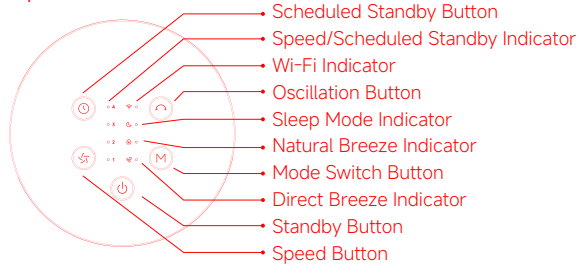

## How to Install

### Step 1: Assemble the base

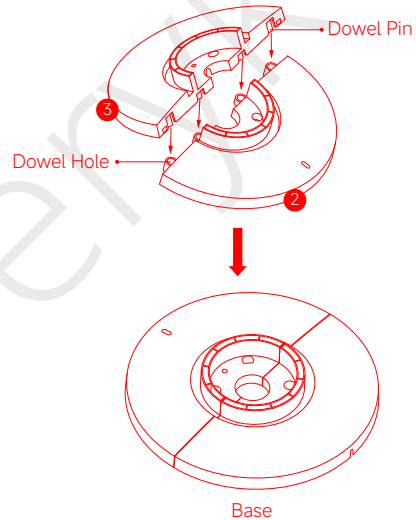

Align the dowel pins of the ③ rear base with the dowel holes of the ② front base and press them into place, so that the rear base and the front base are assembled into a flat one.

## Step 2: Install the base

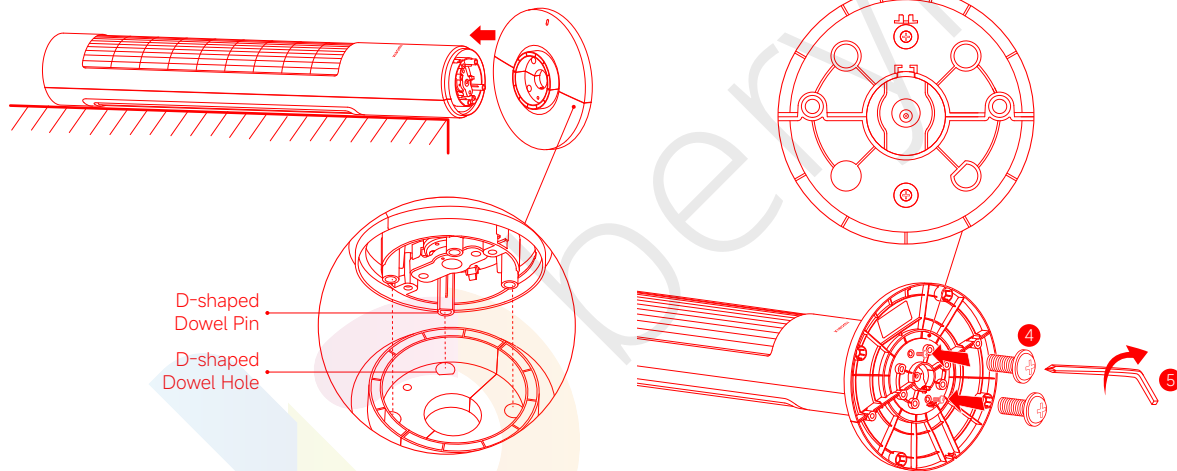

1. Place the fan horizontally on a soft surface. Then insert the D-shaped dowel pin at the bottom of the fan into the D-shaped dowel hole of the base, and press to install the base onto the fan.

2. Put two (4) M5 screws into the screw holes of the base and tighten the screws clockwise with the (5) hex key.

---

### Step 3: Connect the power adapter

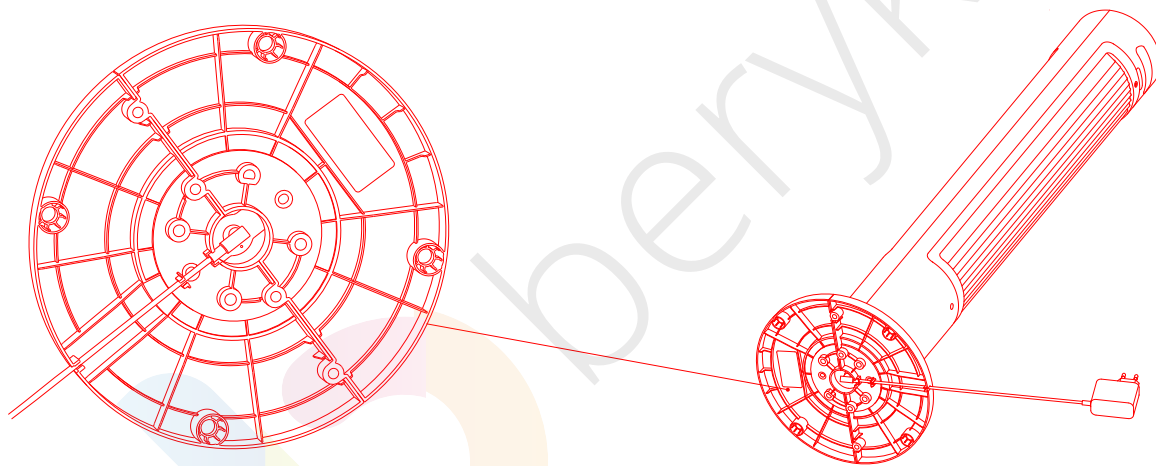

1. Connect the **6** power adapter to the power port at the bottom of the fan.
  2. Install the power cord into the groove at the bottom of the base, and pass it through the end of the groove to complete the installation of the fan.
- Note: Properly straightening out the power cord and installing it into the groove can help keep the power cord from breaking.

# How to Use

## Connecting to an electrical outlet

Plug the power adapter into a suitable electrical outlet. When you hear a beep, the fan is successfully connected to power.

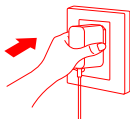

## Turning on/standing by

### Turning on

Press the button  to start the fan. When turned on for the first time, the fan is at the direct breeze mode with the speed level of slow, by default.

### Standing by

Press the button  to stop the fan while it is running.

## Turning off

Unplug the power adapter to turn the fan off.

## Switching the speed

Press the button  to adjust the speed, and the corresponding speed indicator will light up (see table below). After the fan is turned off and turned back on again, the speed will be the last used one.

Indicator	1	2	3	4
Speed level	Slow	Medium	Fast	Turbo
Indicator status	*●●●	●●●●	●●●●	●●●●

### Notes:

- \* means the indicator is on; ● means the indicator is off.
- In the natural breeze mode, the indicators 1, 2, 3, and 4 respectively represent the mode of lakeside, camping, green, and terrace by default. You can go to the app to check the details.

## Switching mode

- Press the button  to cycle through the direct breeze, natural breeze, and sleep mode.
- When in direct breeze or natural breeze mode, the corresponding indicator will remain on.
- In natural breeze mode, pressing the speed button can switch among four natural breeze settings, which are lakeside, camping, green, and terrace. The indicators represent four settings in an order as indicated in the table by default. The order can be changed in the app.

Indicator	1	2	3	4
Natural breeze mode	Lakeside	Camping	Green	Terrace
Indicator status	*●●●	●●●●	●●●●	●●●●

- When switching to sleep mode, the sleep mode indicator will light up and all indicators will then go out if there are no operations within five seconds, to prevent the lights from affecting sleep.
- After the fan is turned off and turned back on again, the mode will be the last used one.

Note: The natural breeze mode can be customized in the Mi Home/Xiaomi Home app.

## Setting the oscillation

Press the button  to enable or disable oscillation. You can set the oscillation angle range in the app. After the fan is turned off and turned back on again, the oscillation setting will be the last used one. Unplug then plug the fan in or reset the Wi-Fi connection, then turn on the fan. It will automatically calibrate its oscillating angle if the oscillation function is enabled. The calibration time varies depending on different angles, please wait with patience.

Note: When the Wi-Fi connection is reset, the oscillation angle range will change to the default angle of 90°.



## Scheduled standby

Press the button  to cycle through the scheduled standby times: 1 hour, 2 hours, 3 hours, 4 hours, and disabled, and the corresponding indicator(s) will light up (see table below). Five seconds after using the scheduled standby function, the indicator(s) resume to indicate the status before scheduling the standby time.

Scheduled standby	Disabled	1 hour	2 hours	3 hours	4 hours
Indicator	●●●●	★●●●	★★●●	★★★●	★★★★

Note: ★ means the indicator is on; ● means the indicator is off.

## Enabling/disabling the Wi-Fi

Simultaneously press and hold the buttons  and  for seven seconds until you hear a notification sound, and then the Wi-Fi is enabled or disabled.

## Resetting the Wi-Fi connection

Simultaneously press and hold the buttons  and . When you hear a long beep, the Wi-Fi has been reset successfully and the fan is awaiting connection. Then follow the instructions in the Mi Home/Xiaomi Home app to connect the fan to the app.

The Wi-Fi connection needs to be reset on the circumstances listed below:

- The Xiaomi Account that the fan is paired with has been changed.
- The router that the fan is connected to has been changed.
- The account or password of the router that the fan is connected to has been changed.
- The Mi Home/Xiaomi Home app is unable to control the fan.

Wi-Fi status & indicator description:

Wi-Fi Status	Awaiting Connection	Connecting	Connected	Fail to Connect	Disabled
Indicator	Blinking orange	Blinking blue	Blue	Orange	Off



## Enabling/disabling the child lock

### Enabling the child lock

To enable the child lock function, go to the Mi Home/Xiaomi Home app, or simultaneously press and hold the buttons  and  for 7 seconds until you hear a long beep.

Once the function is enabled, the fan will not respond if pressing any button but all indicators will blink twice and the fan will beep twice instead.

### Disabling the child lock

To disable the child lock function, go to the Mi Home/Xiaomi Home app, or you can simultaneously press and hold the buttons  and  for 7 seconds until you hear a long beep. Resetting the Wi-Fi or unplugging the power adapter and then turning on the fan can also disable this function.

## Connecting with the Mi Home/Xiaomi Home app

This product works with the Mi Home/Xiaomi Home app\*.

Control your device with Mi Home/Xiaomi Home app.

Scan the QR code to download and install the app.

You will be directed to the connection setup page if the app is installed already. Or search for "Mi Home/Xiaomi Home" in the app store to download and install it. Open the Mi Home/Xiaomi Home app, tap "+" on the upper right, and then follow the instructions to add your device.

\* The app is referred to as Xiaomi Home app in Europe (except for Russia). The name of the app displayed on your device should be taken as the default.

Note: The version of the app might have been updated, please follow the instructions based on the current app version.



1BD15CAA



## Care & Maintenance

### Washable parts: Rear grille & fan blade

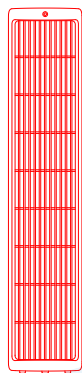

Rear Grille



Fan Blade

After the rear grille and the fan blade are removed, you can clean these parts with a soft cloth or a sponge using water or dilute neutral detergent.

Notes:

- Make sure the fan is disconnected from power before disassembling or cleaning.
- After cleaning the rear grille and the fan blade, dry them in a cool, dry place before installing them for use.
- Avoid direct sunlight during daily use.
- Do not use thinner, gasoline, or detergent to clean any parts.

### Removing the rear grille

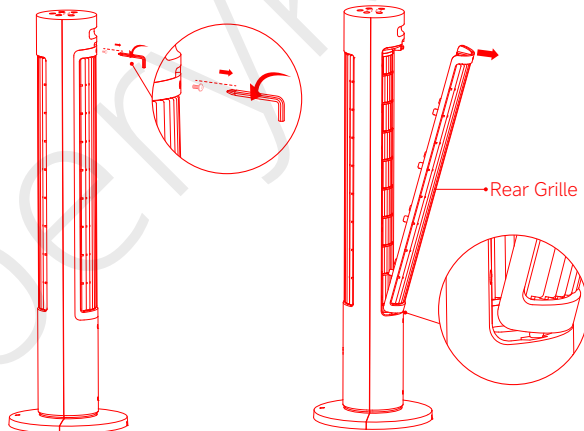

1. Use the **5** hex key to counterclockwise turn the screw that secures the rear grille to remove it.

2. Pull the rear grille outwards from the indentation at the top of the rear grille to remove it.

Note: When installing the rear grille back, first insert the plugs at the bottom of the rear grille into the slots of the rear shell, and then clicks the rear grille into place from the bottom to the top.

## Removing the fan blade

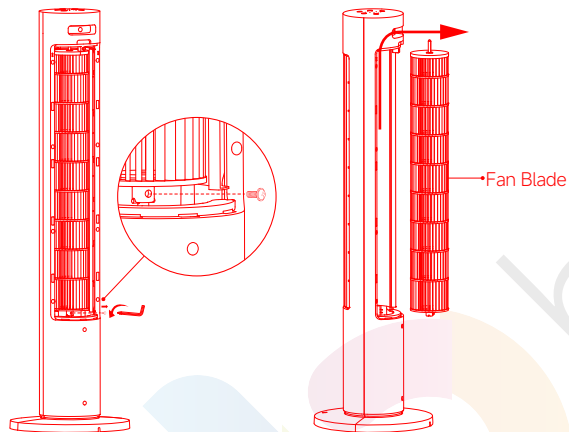

1. Use the **5** hex key to turn the screw at the bottom of the fan blade counterclockwise to remove it.

2. Push the fan blade upward against the top of the compartment, and then pull it outward to remove it.

## Non-washable parts: Fan & power adapter

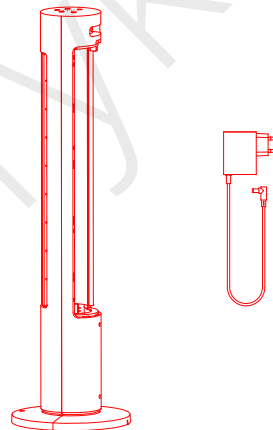

Use a soft, dry cloth to gently wipe the fan and the **6** power adapter.  
Note: Do not use water or other liquids to clean any parts, except for the rear grille and the fan blade.

## Troubleshooting

Issue	Possible Cause	Solution
The fan does not work.	The fan is not connected to power.	Connect the fan to an electrical outlet that meets the fan's requirements.
	The power adapter is not connected properly.	Connect the power adapter properly.
	The child lock function is enabled.	Disable the child lock function.
The fan is unable to connect to Wi-Fi.	The Wi-Fi connection is 5 GHz.	Connect to a 2.4 GHz Wi-Fi network.
	The fan has been offline for more than half an hour.	Reset the Wi-Fi connection.
	Wi-Fi is disabled.	Enable Wi-Fi.
The fan blade is stuck.	The fan blade is stuck by foreign objects.	Unplug the fan and remove foreign objects.
The fan makes unusual sounds when oscillating.	When turned on for the first time, the fan will search for the furthest position to which it can oscillate.	This is normal. The fan will stop making unusual sounds when it has confirmed the furthest position to which it can oscillate.
The oscillation function does not work.	The fan is under the auto-oscillation state.	Wait for the auto-oscillation completes. It will last for 14 seconds at most.

## Specifications

Name	Xiaomi Smart Tower Fan 2	Rated Voltage	12 V $\overline{=}$	Power Cord Length	1.6 m
Model	BPTS02DMU	Rated Power	24 W	Item Dimensions	290 × 290 × 1014 mm
Type	Tower Fan	Noise Emission	≤63 dB(A)	Wireless Connectivity	Wi-Fi IEEE 802.11 b/g/n 2.4 GHz
Net Weight	3.5 kg				
Radio Frequency and Radio Transmission Power					
RF Specification		Working Frequency		Maximum Output Power	
2.4 GHz Wi-Fi		2412–2472 MHz		<20 dBm	
Bluetooth		2402–2480 MHz		<10 dBm	

- To maintain compliance with the RF exposure requirement, a separation distance of 20 cm between the device and the human should be maintained.

Product Information Requirements	Test Data
Maximum Fan Flow Rate (F)	35.86 m <sup>3</sup> /min
Fan Power Input (P)	16.6 W
Service Value (SV)	2.16 (m <sup>3</sup> /min)/W
Maximum Air Velocity (C)	2.81 meters/sec
Measurement Standard for Service Value	EN IEC 60879:2019
Standby Power Consumption (PSB)	Without Wi-Fi connection: 0.222 W With Wi-Fi connection: 0.685 W
Fan Sound Power Level (LWA)	59.4 dB(A)
Seasonal Electricity Consumption (Q)	6.079 kWh/a
Contact Details	Xiaomi Communications Co., Ltd. #019, 9th Floor, Building 6, 33 Xi'erqi Middle Road, Haidian District, Beijing, 100085, China

## Power adapter

Information Published	Value and Precision	Unit
Manufacturer	Shenzhen AMC Technology Co., Ltd.	-
Model Identifier	AD-D1401200200EU01	-
Input Voltage	100-240	V~
Input AC Frequency	50/60	Hz
Output Voltage	12.0	V=
Output Current	2.0	A
Output Power	24.0	W
Average Active Efficiency	86.20	%
Efficiency at Low Load (10%)	73.0	%
No-load Power Consumption	0.10	W

# Regulatory Compliance Information

---

## Europe —EU declaration of conformity



Hereby, Xiaomi Communications Co., Ltd. declares that the radio equipment type BPTS02DMU is in compliance with Directive 2014/53/EU. The full text of the EU declaration of conformity is available at the following internet address:  
<http://www.mi.com/global/service/support/declaration.html>

## Disposal and recycling information



All products bearing this symbol are waste electrical and electronic equipment (WEEE as in directive 2012/19/EU) which should not be mixed with unsorted household waste. Instead, you should protect human health and the environment by handing over your waste equipment to a designated collection point for the recycling of waste electrical and electronic equipment, appointed by the government or local authorities. Correct disposal and recycling will help prevent potential negative consequences to the environment and human health. Please contact the installer or local authorities for more information about the location as well as terms and conditions of such collection points.

# WARRANTY NOTICE

---

THIS WARRANTY GIVES YOU SPECIFIC RIGHTS, AND YOU MAY HAVE OTHER RIGHTS CONVEYED BY LAWS OF YOUR COUNTRY, PROVINCE OR STATE. INDEED, IN SOME COUNTRIES, PROVINCES OR STATES, CONSUMER LAW MAY IMPOSE A MINIMUM WARRANTY PERIOD. OTHER THAN AS PERMITTED BY LAW, XIAOMI DOES NOT EXCLUDE, LIMIT OR SUSPEND OTHER RIGHTS YOU MAY HAVE. FOR A FULL UNDERSTANDING OF YOUR RIGHTS WE INVITE YOU TO CONSULT THE LAWS OF YOUR COUNTRY, PROVINCE OR STATE.

## 1. LIMITED PRODUCT WARRANTY

XIAOMI warrants that the Products are free from defects in materials and workmanship under normal use and use in accordance with the respective Product user manual, during the Warranty Period.

The duration and conditions related to the legal warranties are provided by respective local laws. For more information about the consumer warranty benefits, please refer to Xiaomi's official website <https://www.mi.com/global/support/warranty>.

Xiaomi warrants to the original purchaser that its Xiaomi Product will be free from defects in materials and workmanship under normal use in the period mentioned above.

Xiaomi does not guarantee that the operation of the Product will be uninterrupted or error free.

Xiaomi is not liable for damages arising from non-compliance with the instructions related to the use of the Product.

## 2. REMEDIES

If a hardware defect is found and a valid claim is received by Xiaomi within the Warranty Period, Xiaomi will either (1) repair the product at no charge, (2) replace the product, or (3) refund the Product, excluding potential shipping costs.

## 3. HOW TO OBTAIN WARRANTY SERVICE

To obtain warranty service, you must deliver the Product, in its original packaging or similar packaging providing an equal degree of Product protection, to the address specified by Xiaomi. Except to the extent prohibited by applicable law, Xiaomi may require you to present proofs or proof of purchase and / or comply with registration requirements before receiving warranty service.

## 4. EXCLUSIONS AND LIMITATIONS

Unless otherwise stipulated by Xiaomi, this Limited Warranty applies only to the Product manufactured by or for Xiaomi and identifiable by the trademarks, trade name or "Xiaomi" or "Mi" logo.

The Limited Warranty does not apply to any (a) Damage due to acts of nature or God, for example, lightning strikes, tornadoes, flood, fire, earthquake or other external causes; (b) Negligence; (c) Commercial use; (d) Alterations or modifications to any part of the Product; (e) Damage caused by use with non-Xiaomi products; (f) Damage caused by accident, abuse or misuse; (g) Damage caused by operating the Product outside the permitted or intended uses described by Xiaomi or with improper voltage or power supply; or (h) Damage caused by service (including upgrades and expansions) performed by anyone who is not a representative of Xiaomi.

---

It is your responsibility to backup any data, software, or other materials you may have stored or preserved on the product. It is likely that the data, software or other materials in the equipment will be lost or reformatted during the service process, Xiaomi is not responsible for such damage or loss. No Xiaomi reseller, agent, or employee is authorized to make any modification, extension, or addition to this Limited Warranty. If any term is held to be illegal or unenforceable, the legality or enforceability of the remaining terms shall not be affected or impaired.

Except as prohibited by laws or otherwise promised by Xiaomi, the after-sales services shall be limited to the country or region of the original purchase. Products which were not duly imported and/or were not duly manufactured by Xiaomi and/or were not duly acquired from Xiaomi or a Xiaomi's official seller are not covered by the present warranties. As per applicable law you may benefit from warranties from the non-official retailer who sold the product. Therefore, Xiaomi invites you to contact the retailer from whom you purchased the product.

The present warranties do not apply in Hong Kong and Taiwan.

## 5. IMPLIED WARRANTIES

Except to the extent prohibited by applicable law, all implied warranties (including warranties of merchantability and fitness for a particular purpose) will have a limited duration up to a maximum duration of this limited warranty. Some jurisdictions do not allow limitations on the duration of an implied warranty, so the above limitation will not be applied in these cases.

## 6. DAMAGE LIMITATION

Except to the extent prohibited by applicable law, Xiaomi shall not be liable for any damages caused by accidents, indirect, special or consequential damages, including but not limited to loss of profits, revenue or data, damages resulting from any breach of express or implied warranty or condition, or under any other legal theory, even if Xiaomi has been informed of the possibility of such damages. Some jurisdictions do not allow the exclusion or limitation of special, indirect, or consequential damages, so the above limitation or exclusion may not apply to you.

## 7. XIAOMI CONTACTS

For customers, please visit the website: <https://www.mi.com/global/support/warranty>

The contact person for the after-sale service may be any person in Xiaomi's authorized service network, Xiaomi's authorized distributors or the final vendor who sold the products to you. If in doubt please contact the relevant person as Xiaomi may identify.

berylko

Importer:  
Beryko s.r.o.  
Pod Vinicemi 931/2, 301 00 Plzeň  
[www.berylko.cz](http://www.berylko.cz)

**EU REP:**  
Xiaomi Technology Netherlands B.V.  
Prinses Beatrixlaan 582, 2595BM, The Hague, The Netherlands  
[contact@support.mi.com](mailto:contact@support.mi.com)

